



Apartment (EPC Rating: B)

RIVERSIDE **BISHOP'S STORTFORD** **CM23 3GN** **Per Month** **£1,200 Per Month**

- AVAILABLE NOW
- UNFURNISHED
- LARGE ONE BEDROOM APARTMENT
- ALLOCATED PARKING SPACE
- BEAUTIFULLY PRESENTED
- FULLY FITTED KITCHEN
- LOUNGE/DINER
- BATHROOM
- TOWN CENTRE LOCATION
- GAS & WATER BILLS INCLUDED IN THE RENT



Fordyce Furnivall
 Residential Sales & Letting Agents



1



1



1



B

1 Bedroom Apartment located in Bishop's Stortford

Being offered unfurnished and available now, a larger than average one double bedroom second floor apartment overlooking the courtyard, situated in the heart of Bishop's Stortford only 2 minutes' walk from the mainline railway station to London's Liverpool Street and to the High Street shops and shopping centre. The well presented accommodation comprises an open plan kitchen/diner and lounge area, bedroom and bathroom. The large kitchen area comes fully fitted with an oven, hob with extractor fan over, fridge/freezer, ample wall and floor units with work surfaces over. Additional features include one allocated parking space, UPVC double glazed windows and gas central heating which is included in the rent.

COMMUNAL ENTRANCE

Lift & stairs up to all floors, door to secure parking, post room and bike store.

SECOND FLOOR

Door to the apartment.

ENTRANCE HALL

Storage cupboard housing washing machine, doors off to:

OPEN PLAN LOUNGE/DINER/KITCHEN

22'5" x 16'6"

Kitchen fully fitted with electric oven with ceramic hob, extractor hood over, fridge/freezer, dishwasher, stainless steel sink, range of wall and base units. Window to the front aspect, radiators, laminate flooring TV point.

BEDROOM

9'4" x 14'6"

Window to the front aspect, radiator, TV point, carpet flooring.

BATHROOM

Bath with shower over, glass screen, pedestal wash hand basin, low flush WC, chrome heated towel rail

PARKING

One allocated parking space

COMMUNAL GARDENS

Communal gardens running along side the river.

LOCAL AUTHORITY

East Herts District Council

Tax Band: B

£1,819.71



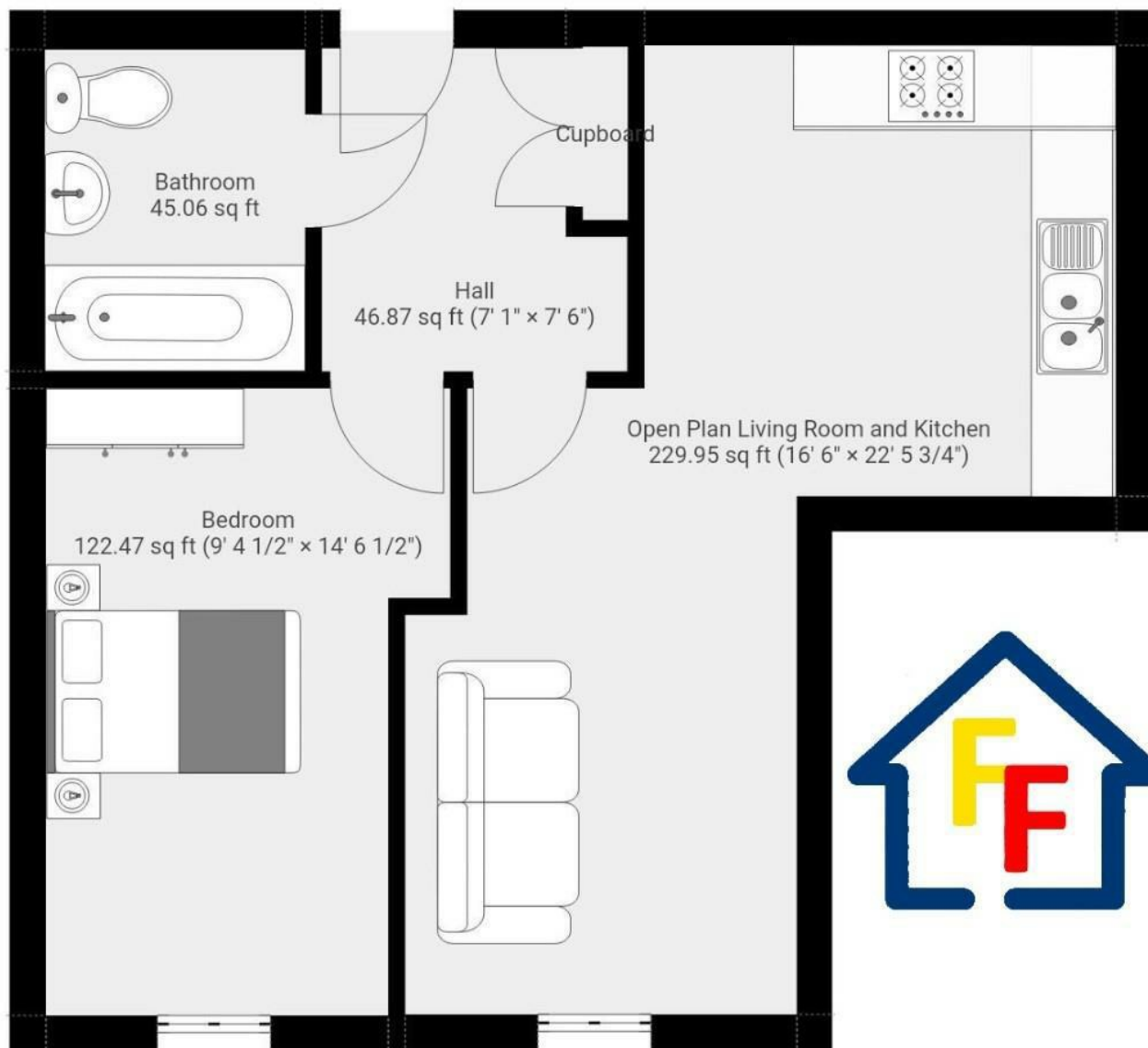

Whilst every attempt has been made to ensure the accuracy of the floorplan contained here, measurements of doors, windows, rooms and any other items are approximate and no responsibility is taken for any error, omission or mis-statement. This plan is for illustrative purposes only and should be used as such by any prospective purchaser. The services, systems and appliances shown have not been tested and no guarantee as to their operability or efficiency can be given.

Council Tax Band

B

Energy Performance Graph

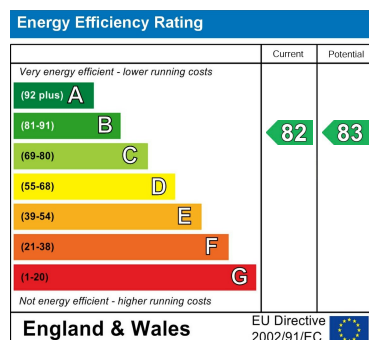

Call us on

01279 658758

lettings@fordycefurnivall.co.uk

www.fordycefurnivall.co.uk

Agents Note: Whilst every care has been taken to prepare these particulars, they are for guidance purposes only. All measurements are approximate and are for general guidance purposes only and whilst every care has been taken to ensure their accuracy, they should not be relied upon and potential buyers are advised to recheck the measurements.